

Check Valve

Y-Spring Check Valve (PN16)

Model: 500 009

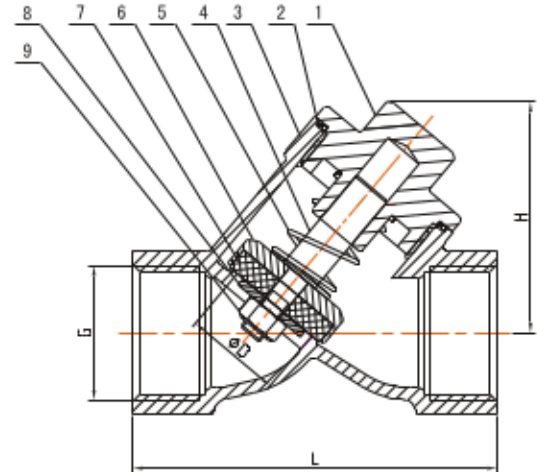

Function Principle

The medium enters valve body through inlet opening, pushes the valve stem and valve core upward, and thereby opens the valve. When the medium starts to flow back from the outlet, the spring force and pressure applied by the medium itself push the valve stem and valve core down, and thereby close the valve.

Technical Specification

Nominal pressure: PN16

Valve specification: DN15–DN50

Medium temperature: -10°C — $+180^{\circ}\text{C}$

Open pressure: 30–40mbar

Connection: Thread, welding fast mounting, flange

Part List

| NO. | Name | Material |
|-----|------------------|----------|
| 1 | Bonnet | CF8/CF8M |
| 2 | Body seal | PTFE |
| 3 | Body | CF8/CF8M |
| 4 | Spring | 304 |
| 5 | Stem | 304/316 |
| 6 | Core | CF8/CF8M |
| 7 | Seat | PTFE |
| 8 | Core gasket | CF8/CF8M |
| 9 | Self-locking Nut | 304 |

Main Dimension (thread type)

| SIZE | 1/2" | 3/4" | 1" | 1 1/4" | 1 1/2" | 2" |
|----------|------|------|----|--------|--------|-----|
| L | 68 | 75 | 90 | 116 | 116 | 138 |
| H | 43 | 48.5 | 57 | 72 | 77 | 89 |
| ϕD | 13 | 18 | 24 | 31 | 35 | 45 |
| G | 1/2" | 3/4" | 1" | 1 1/4" | 1 1/2" | 2" |

Check Valve

Wafer Type Disc Check Valve

Model: 500 008

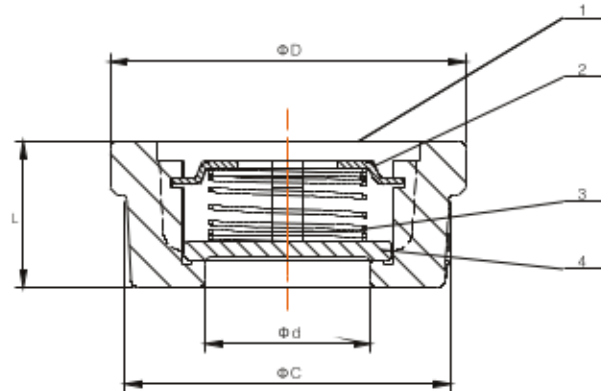

Flange standards: DIN PN16, 25, 40
ANSI 150/300 Lbs
Structure length: DIN3202 – K4
Pressure level: PN40
Material: CF8 /CF8M

Technical Specification

| ITEM \ SIZE | DN15 | DN20 | DN25 | DN32 | DN40 | DN50 | DN65 | DN80 | DN100 |
|--|------|------|------|------|------|------|------|------|-------|
| MIN Open pressure (mbar) | 35 | 35 | 35 | 35 | 35 | 35 | 35 | 35 | 35 |
| Kv(m ³ /h) at 0.1bar ΔP | 0.45 | 0.75 | 1.2 | 1.8 | 2.6 | 4.2 | 5.8 | 9.5 | 15 |

Main Dimension

| ITEM \ SIZE | DN15 | DN20 | DN25 | DN32 | DN40 | DN50 | DN65 | DN80 | DN100 |
|-------------|------|------|------|------|------|------|------|------|-------|
| D | 39 | 46 | 54 | 70 | 80 | 94 | 112 | 132 | 150 |
| d | 15 | 20 | 25 | 32 | 40 | 46 | 62 | 75 | 86 |
| C | 34 | 40 | 50 | 62 | 70 | 85 | 100 | 120 | 140 |
| L | 16 | 19 | 22 | 28 | 32 | 40 | 46 | 50 | 60 |

Part List

| NO | Name | Material |
|----|----------------|----------|
| 1 | Body | CF8/CF8M |
| 2 | Spring support | 316 |
| 3 | Spring | 304/316 |
| 4 | Disc | CF8/CF8M |

Check Valve

Wafer Type Dual Disk Check Valve (PN16)

Model: 500 006

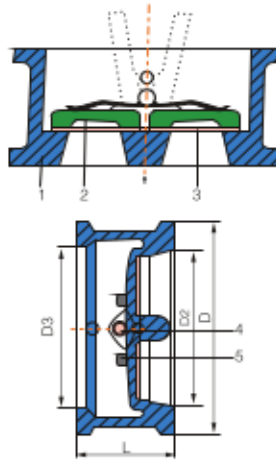

Part List

| NO | Name | Material |
|----|--------|------------------------------|
| 1 | Body | CF8, CF8M, |
| 2 | Disc | CF8, CF8M, |
| 3 | Seat | EPDM |
| 4 | Holder | Stainless steel (304 or 316) |
| 5 | Spring | Stainless steel (304 or 316) |

Main Dimension

| Size | 50 | 65 | 80 | 100 | 125 | 150 | 200 | 250 | 300 | 350 | 400 | 450 | 500 | 600 |
|------|-----|-----|-----|-----|-----|-----|-----|-----|-----|-----|-----|-----|-----|-----|
| L | 60 | 67 | 73 | 73 | 86 | 98 | 127 | 146 | 181 | 184 | 191 | 203 | 219 | 222 |
| D | 108 | 128 | 142 | 162 | 192 | 218 | 273 | 328 | 378 | 438 | 489 | 539 | 594 | 695 |
| D2 | 51 | 65 | 80 | 102 | 127 | 152 | 203 | 254 | 305 | 350 | 400 | 450 | 500 | 600 |
| D3 | 56 | 73 | 88 | 108 | 132 | 160 | 210 | 266 | 310 | 355 | 405 | 455 | 505 | 605 |

Wafer Type Swing Check Valve (PN16)

Model: 500 007

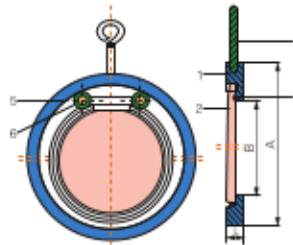

Part List

| NO | Name | Material |
|----|----------|---------------------|
| 1 | Body | CS, CF8, CF8M, |
| 2 | Disc | CS, CF8, CF8M |
| 3 | Eye Bolt | Carbon Steel Plated |
| 4 | O-Ring | FKM, NBR, EPDM |
| 5 | Bolt | SS304, SS316 |
| 6 | Washer | FKM, NBR, EPDM |

Main Dimension

| Size | 40 | 50 | 65 | 80 | 100 | 125 | 150 | 200 | 250 | 300 |
|------|----|-----|-----|-----|-----|-----|-----|-----|-----|-----|
| B | 24 | 28 | 45 | 55 | 76 | 93 | 118 | 160 | 200 | 230 |
| A | 93 | 108 | 128 | 142 | 162 | 192 | 218 | 273 | 329 | 385 |
| L | 16 | 16 | 16 | 16 | 16 | 16 | 19 | 28 | 28 | 38 |

Check Valve

3-PC Spring Vertical Check Valve (PN63)

Model:500 004

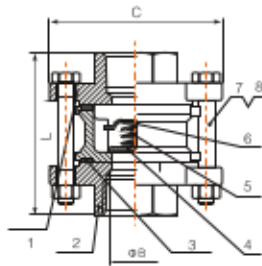

Part List

| NO | Name | Material |
|----|--------|----------|
| 1 | Body | CF8/CF8M |
| 2 | Bonnet | CF8M |
| 3 | Seal | PTFE |
| 4 | Disc | 304 |
| 5 | Spring | 304 |
| 6 | Plug | 304 |
| 7 | Bolt | 304 |
| 8 | Nut | 304 |

Main Dimension

| Size | 1/4" | 3/8" | 1/2" | 3/4" | 1" | 1 1/4" | 1 1/2" | 2" | 2 1/2" | 3" | 4" |
|------|------|------|------|------|----|--------|--------|-----|--------|-----|-----|
| B | 8 | 10 | 15 | 20 | 25 | 32 | 40 | 50 | 65 | 76 | 94 |
| C | 45 | 45 | 53.5 | 62.5 | 71 | 88 | 95 | 117 | 147 | 167 | 224 |
| L | 48.5 | 48.5 | 56.5 | 65 | 74 | 83 | 92 | 110 | 125.5 | 141 | 164 |

Wafer Type Disc Check Valve (PN25, PN40)

Model: 500 005

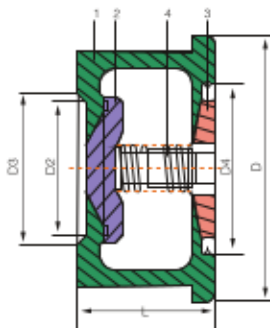

Part List

| NO | Name | Material |
|----|--------|---------------|
| 1 | Body | CS, CF8, CF8M |
| 2 | Disc | CF8, CF8M |
| 3 | Holder | CS, CF8, CF8M |
| 4 | Spring | 304, 316 |

Main Dimension

| Size | | 15 | 20 | 25 | 32 | 40 | 50 | 65 | 80 | 100 | 125 | 150 | 200 | 250 |
|------|---|----|----|----|----|----|-----|-----|-----|-----|-----|-----|-----|-----|
| PN25 | L | 25 | 25 | 30 | 32 | 38 | 45 | 50 | 60 | 75 | 85 | 102 | 110 | 150 |
| | D | 52 | 62 | 72 | 83 | 93 | 108 | 128 | 142 | 168 | 194 | 224 | 284 | 341 |
| PN40 | L | 25 | 25 | 30 | 32 | 38 | 45 | 50 | 60 | 75 | 85 | 102 | 110 | 150 |
| | D | 52 | 62 | 72 | 83 | 93 | 108 | 128 | 142 | 168 | 194 | 224 | 291 | 353 |

Check Valve

Y-Spring Check Valve (PN55)

Model: 500 001

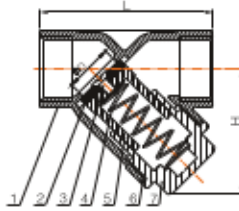

Part List

| NO | Name | Material |
|----|------------|----------|
| 1 | Body | CF8/CF8M |
| 2 | Seat | PTFE |
| 3 | Sunk Screw | 316 |
| 4 | Spring | 304 |
| 5 | Sleeve | CF8/CF8M |
| 6 | Gasket | PTFE |
| 7 | Bonnet | CF8/CF8M |

Main Dimension

| SIZE | 1/4" | 3/8" | 1/2" | 3/4" | 1" | 1 1/4" | 1 1/2" | 2" |
|------|------|------|------|------|----|--------|--------|-----|
| ΦD | 14 | 14 | 14 | 20 | 25 | 32 | 40 | 50 |
| H | 44 | 44 | 44 | 52 | 65 | 70 | 78 | 90 |
| L | 65 | 65 | 65 | 80 | 90 | 105 | 120 | 138 |

Swing Check Valve(PN16)

Model: 500 002

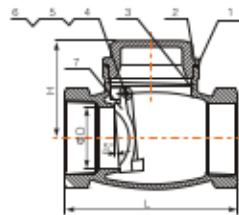

Part List

| NO | Name | Material |
|----|-------------|----------|
| 1 | Bonnet | CF8/CF8M |
| 2 | Gasket | PTFE |
| 3 | Body | CF8/CF8M |
| 4 | Pin | 304 |
| 5 | Plug gasket | PTFE |
| 6 | Plug | 304 |
| 7 | Disc | CF8/CF8M |

Main Dimension

| SIZE ITEM | 1/2" | 3/4" | 1" | 1 1/4" | 1 1/2" | 2" |
|--------------|------|------|----|--------|--------|-----|
| ΦD | 15 | 20 | 25 | 32 | 40 | 50 |
| L | 65 | 79 | 90 | 103.5 | 120 | 140 |
| H | 43 | 53 | 62 | 66.5 | 80.5 | 84 |

2-PC Spring Vertical Check Valve(PN63)

Model: 500 003

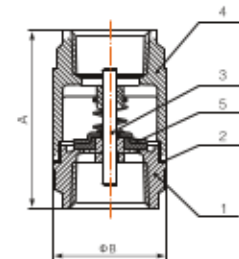

Part List

| NO | Name | Material |
|----|--------|----------|
| 1 | Bonnet | CF8/CF8M |
| 2 | Gasket | PTFE |
| 3 | Stem | 304/316 |
| 4 | Body | CF8M |
| 5 | Disc | 304/316 |

Main Dimension

| SIZE | 1/4" | 3/8" | 1/2" | 3/4" | 1" | 1 1/4" | 1 1/2" | 2" |
|------|------|------|------|------|----|--------|--------|-----|
| A | 51 | 51 | 61 | 69 | 82 | 92 | 107 | 120 |
| ΦB | 30.5 | 30.5 | 37 | 42 | 48 | 58 | 70 | 82 |